

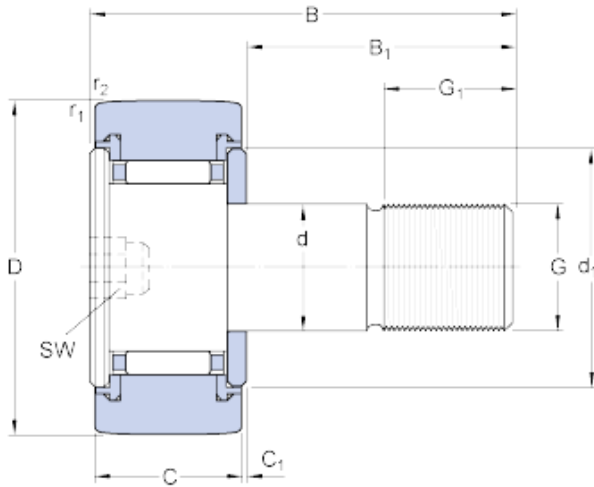

MSD MANUFACTURING CO.,LTD.



6 mm x 16 mm x 28 mm skf KR 16 PPSKA Track rollers,Cam followers

Bearing No. KR 16 PPSKA

KR 16 PPSKA Bearing 2D drawings and 3D CAD models

Size	6x16x28 mm
Bore Diameter	6 mm
Outer Diameter	16 mm
Width	28 mm
D	16 mm
d	6 mm
B	28 mm
C	11 mm
B ₁	16 mm
C ₁	0.6 mm
d ₁	12.5 mm
G	M 6
G ₁	8 mm
SW	4 mm
r _{1,2} - min.	0.15 mm
Basic dynamic load rating - C	3.1 kN
Basic static load rating - C ₀	3.2 kN
Fatigue load limit - P _u	0.345 kN
Maximum dynamic radial loads - F _r	2.9 kN
Maximum static radial loads - F _{0r}	4.2 kN
Limiting speed	6000 r/min
Mass support roller	0.019 kg



MSD MANUFACTURING CO.,LTD.

Recommended tightening torque	3 N · m
Category	Cam Follower and Track Roller - Stud Type
Inventory	0.0
Manufacturer Name	SKF
Minimum Buy Quantity	N/A
Weight / Kilogram	0.02
EAN	7316571594446
Product Group	B04144
Roller Surface Profile	Crowned
Profile	Stud Type
Thread Size	M6X1
Stud Profile	Standard Stud
Enclosure	Sealed
Rolling Element	Needle Bearing
Relubricatable	No
Hex Socket	Yes
Inch - Metric	Metric
Other Features	Caged Polyamide 66 Axial Sliding 3 Stage Sealing
Long Description	16MM Roller Diameter; 11MM Roller Width; Crowned Roller Surface; Stud Type; 6MM Stud Diameter; M6X1 Thread; Standard Stud; Sealed; Needle Bearing; Not Relubricatable; Hex Socket
Category	Cam Followers Stud Type
UNSPSC	31171530
Harmonized Tariff Code	8482.40.00.00
Noun	Bearing
Keyword String	Cam Follower
Manufacturer URL	http://www.skf.com



MSD MANUFACTURING CO.,LTD.

Manufacturer Item Number	KR 16 PPSKA
Weight / LBS	0.04
Stud Diameter	0.236 Inch 6 Millimeter
Roller Diameter	0.63 Inch 16 Millimeter
Roller Width	0.433 Inch 11 Millimeter
B_1	16 mm
C_1	0.6 mm
d_1	12.5 mm
G_1	8 mm
$r_{1,2}$ min.	0.15 mm
Basic dynamic load rating C	3.14 kN
Basic static load rating C_0	3.2 kN
Fatigue load limit P_u	0.345 kN
Maximum dynamic radial loads F_r max.	2.9 kN
Maximum static radial loads F_{0r} max.	4.15 kN
Mass cam follower	0.019 kg
Hexagonal nut	M 6x1